

USER MANUAL

Atmospheric Water Generator Type: P50 3rd Generation



- It is highly recommended to read this manual before use.
- Please keep this manual for future reference.

INTRODUCTION

Dear user.

Congratulations on your purchase of our Atmospheric Water Generator. Our commitment is to provide you with healthy sustainable drinking water that is good for you and the environment.

Water is an essential resource to all biological life. Without water there would be no life. 70.8% of the earth's surface is covered by water. Just 3% of the water is fresh water. Most of the fresh water is locked in icecaps and glaciers. All the lakes, rivers and swamps only account for 0.3% of available fresh water.

There is an estimated 12 Quintillion litres of water in the earth's atmosphere; that's 10 times more than all the rivers, lakes and swamps combined.

With global warming, rise in population, industrial growth and agricultural demand. Recent scientific research estimates that by 2050 the entire globe will be under severe water stress. At present 1.2 billion people do not have access to safe drinking water.

Water pollution has also become a serious threat to personal health. Harmful chemicals have been found in numerous water supplies including leaching harmful chemicals from the containers that the water has been stored in.

The use of Atmospheric Water Generators is beneficial to personal health and the environment by producing pure chemical and bacteria free water and eliminating the risks of contamination from storage containers. This in turn reduces the demand on ground water and the production of plastic bottles.

ATTENTION:

- Read the manual before connecting to electricity.
- Please keep this manual for future reference.
- Production date and serial number refer to barcode.

CONTENTS

• Introduction	Page 1
• Contents	Page 2
• Product Introduction	Page 3
• Product Features	Page 3
• Safety Precautions	Page 4-5
• Product Map	Page 6
• Installation Guide	Page 7
• How it Works	Page 8
• Additional Benefits	Page 9
• Display Introduction	Page 10
• Functions	Page 10-11
• Operating Instructions	Page 12-14
• Care & Maintenance	Page 14-15
• Air Filter Replacement and Reset	Page 15
• Water Filter Replacement and Reset	Page 15-16
• External Water Inlet	Page 17
• External Water Adapter	Page 18
• Trouble Shooting	Page 18-19
• Fault Codes	Page 19
• Technical Specifications	Page 20
• Packing List	Page 20
• Replacement Filters	Page 21
• Circuit Diagram	Page 21
• Warranty	Page 22

1. Product Introduction

- The Atmospheric Water Generator is a high-tech water supply machine that provides the highest quality drinking water by harvesting water from the humidity in the air. This process in turn dehumidifies and purifies the air in the room.
- The Atmospheric Water Generator is designed for multiple applications. Residential, commercial, industrial, hospitality, medical and marine use.

2. Product Features

- Multiple filtration system.
- Manufactured from high quality food grade materials.
- Microcomputer control technology for automatic operation.
- Option to connect to external water supply.
- Advanced water filtration system to ensure pure drinking water.

3. Safety Precautions

- ⚠ Do not attempt to repair the machine or power cable. Contact your local dealer for service support.
- ⚠ Only connect the unit to an appropriate power supply.
- ⚠ Do not pull or damage the power cable.
- ⚠ Do not connect the power supply with wet hands.
- ⚠ Keep the power cable out of reach of children.



- ⚠ To prevent damage to the machine, disconnect power supply during thunderstorms.



- ⚠ Disconnect the power supply before cleaning or maintenance.



- ⚠ Do not use multiple connections on the machine's power supply connection.
- ⚠ Do not place or use the machine in volatile, corrosive or flammable chemical environments.



- ⚠ Should abnormal sounds, smell, temperature or leakage occur, disconnect from power supply and contact your local dealer for service support.
- ⚠ Do not place any objects on top of the unit.



- ⚠ Always keep the unit in an upright position.
- ⚠ Do not place any flammable objects within 40 cm of the back of the machine because of hot exhaust air.
- ⚠ When moving the machine, the water tank must be drained to avoid water spillage within the machine.
- ⚠ To prolong the air filter lifespan place unit in the best possible location.
- ⚠ The machine should be operated in temperatures above zero.
- ⚠ Do not remove the back cover of the machine.
- ⚠ Children should be supervised when operating the machine.

4. Product Map.

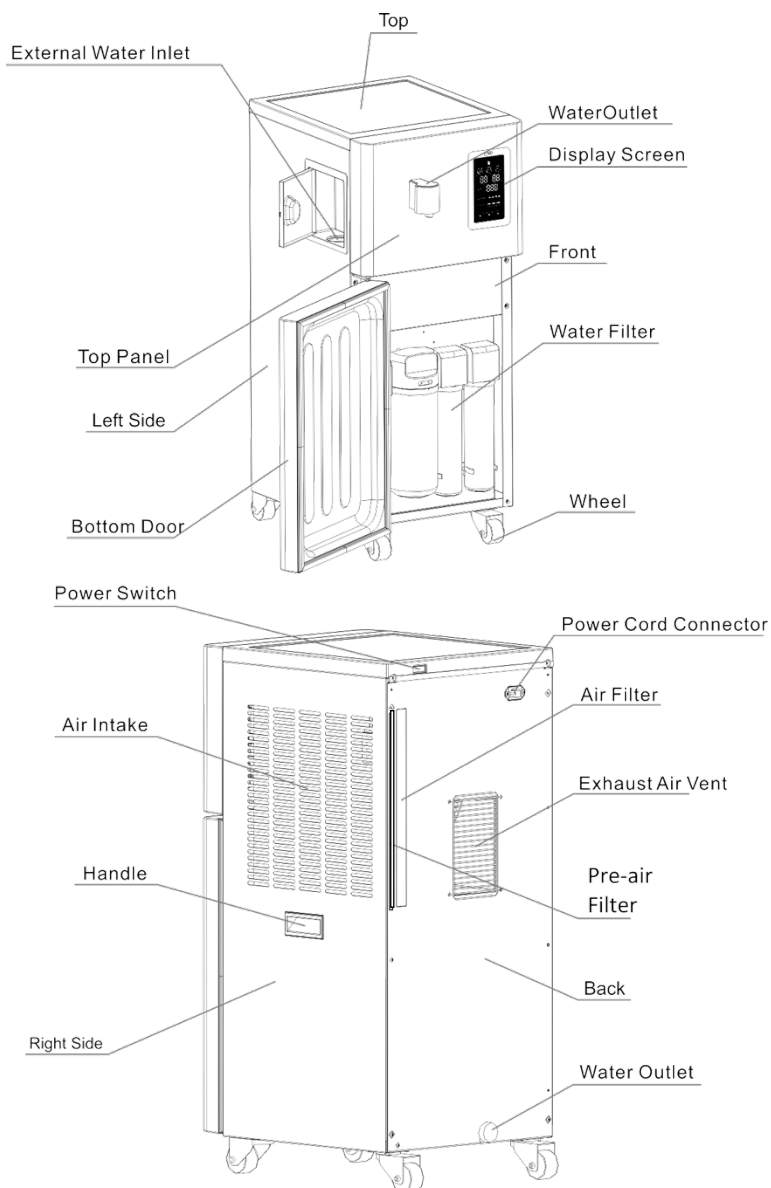

- Any changes of the manual for the improvements of the products will not be given.

5. Installation Guide

- The machine must be placed on a firm horizontal surface.
- Avoid fitting the machine at any angles or may result in excessive noise during operation.
- Ensure a minimum gap of 200 mm between machine and walls to allow sufficient cooling and ventilation.

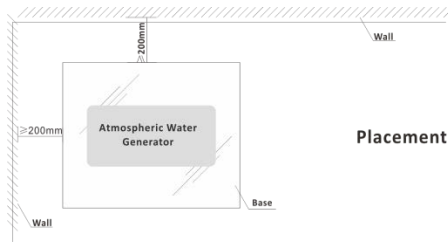

P1

- Leave the machine in its final position for 4 hours before turning the power on. This will allow for optimum operation.

First Use Reminder:

During first time use, the machine will automatically run a 10 min long filter flushing mode when the collection water tank level reaches (M) level (around 3~6 liters). There will be a Beep sound when automatic flushing is complete. You must then drain the water tank from the water outlet. The next tank of water produced is ready for drinking.

Tip: To save waiting time, you can add bottle or municipal water (3 liters above) to the External Water Inlet then wait for automatic flushing mode to complete and then drain the tank.

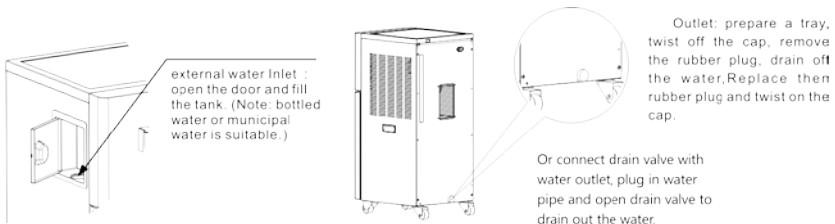

P2

- Ensure the machine is positioned with enough ventilation.

6. How It Works

Water is produced by condensing water vapor in the air. Warm humid air is drawn into the machine and passed through a patented triple layer aerospace technology air filter and then cooled to below dew point temperature.

As the air cools, condensation naturally occurs and is collected in the Water Tank.

During water dispensing, the water is pumped from the water tank through a multistage nanoscale filtration system and inline UV light sterilization for purification and sterilization each time water is dispensed.

To maintain the water quality within water tank, automatic circulation, circulates and purifies the water every 12 hours for 10 minutes for the collection water tank. In addition, inline UV fitted within Water Tank automatically turn on for 30 min every 90 min to eliminate and prevent bacterial propagation within the Water Tank.

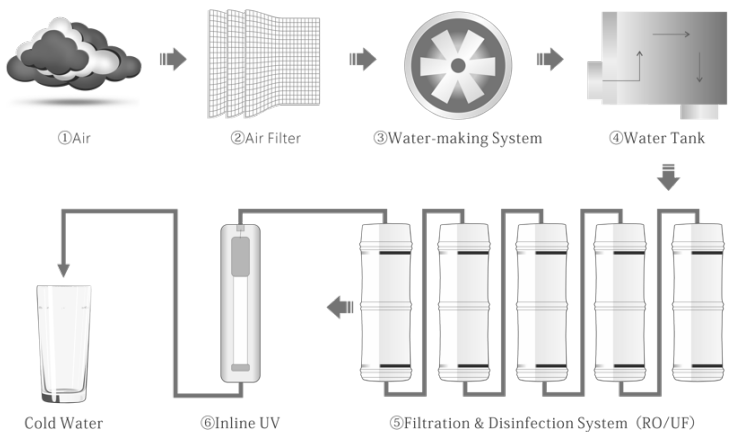

7. Additional Benefits

There are numerous benefits that cover personal health, the environment and also economic benefits. Below are just a few of the many benefits.

- Sustainable water supply.
- Zero waste water production.
- Bottle free.
- Reduction in emissions from manufacturing of plastics.
- Reduction in transportation emissions.
- Water produced creates savings compared to bottled water costs.
- Can be installed anywhere in a building without installing water lines.
- No bulky water container storage space required.
- No more delivery or collection disruptions.
- No heavy lifting of heavy water containers.
- Chemical free.
- Fluoride free.
- Carcinogen free.
- Bacteria free.
- Natural Minerals.
- Dehumidifies the room.
- Purifies the air in the room.
- Reduces allergen particles in the air.

8. Display Introduction

Atmospheric Water Generator Display (P3)

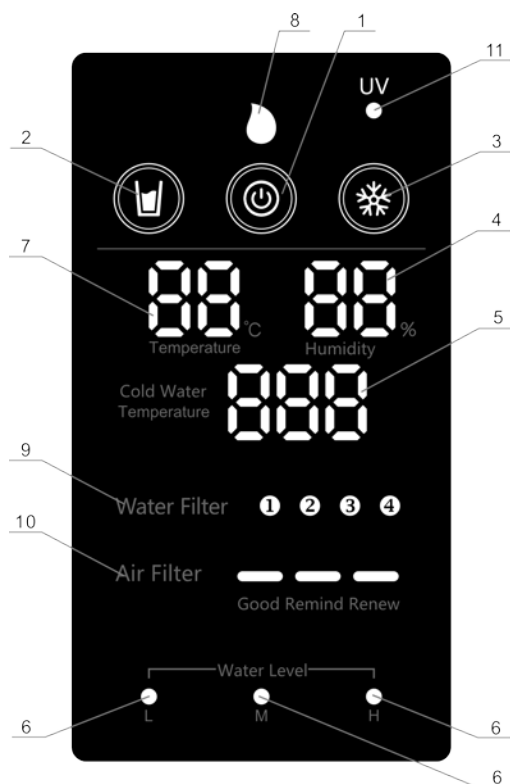

- | | | | |
|----------------------------|----|--------------------|---------------|
| 1 .On/Off | P3 | 6 . Water Level | 11 . UV light |
| 2 .Water | | 7 .Temperature | |
| 3 .Refrigeration on/off | | 8 . Working Status | |
| 4 . Humidity | | 9 . Water Filter | |
| 5 . Cold water temperature | | 10 . Air Filter | |

Functions

1. On/Off

Press 5s to turn water making function On and press 5s again to turn water making function Off.

2. Water

Touch and hold for dispensing water.

3. Refrigeration on/off

Press 5s for On/Off refrigeration mode. If off, will dispense ambient water.

4. Humidity

This shows the ambient humidity in the room.

5. Cold Water Temperature

This shows pure cold water temperature, if refrigeration off, will be ambient water temperature.

6. Water Level

There are 3 water levels (H)igh, (M)edium & (L)ow each are displayed with white lights. (L) will flash when the cold water tank level is too low empty.

7. Temperature

This shows ambient temperature of the room.

8. Working Status

Flashing indicates water making or refrigeration mode is running.
Constantly on indicates machine is ready to make water.
Off indicates water making function is Off.

9. Water Filter

This shows the condition of each water filter (1-4) The lights will be illuminated green when the water filters are in good condition and illuminated red flashing need to be replaced.

10. Air Filter

Shows condition of the air filter in 3 levels (Good, Renew & Replace)
When Renew is illuminated red flashing ,the Air Filter must be replaced.

11. UV light

When pure water tank above L level, UV light will turn on for 30 min every 90 min. When dispensing water, UV light will be illuminated.

9. Operating Instructions

Note: \leq \leq means light flashing, \leq means light on.

- (1) Plug the machine into power outlet and turn on the switch at the back top of the machine. The buzzer will beep once. The machine will run a short diagnostic test. The display will light up and the machine will start producing water automatically after 3 min.
- (2) Provided the temperature is above 15°C with the humidity above 25% the machine will produce water.
- (3) Water level shows the pure water tank level, if the water level of the water tank is too low or empty, (L) level light flashes and the machine will not allow water dispensing. Wait until the tank level reaches (L) level constantly on or higher levels.

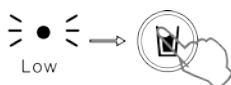
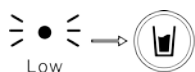

- (4) Low, medium or high levels of the pure water tank. The machine will allow dispensing of water.

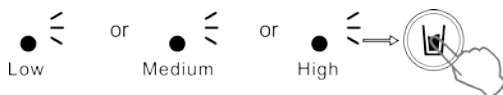

- (5) Hold water button for dispensing water



Later



Drinking Water

- (6)

- (7) Refrigeration ON/OFF mode, When on, the indicator is illuminated and the machine will dispense cold water (temperature range 8~15°C). When off, the machine will dispense the ambient water.



- (8) The condition of the water filters are displayed with a number that is normally illuminated steady green. When the light changes to red flashing it is time to replace the appropriate filter.

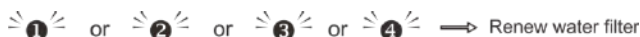

- (9) Shows condition of the air filter in 3 levels (Good, Renew & Replace) When Renew is illuminated the Air Filter must be replaced.

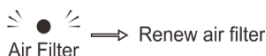

- (10) Water circulation. The water in the collection water tank will be circulated automatically every 12 hours for 10 minutes. If the machine was disconnected from power, the collection water tank will be circulated for 2 minutes when water tank above Low for the next switched connected to power.

- (11) When the pure water tank is full, the compressor will switch off and the fan will switch off after 60 seconds and (H) on the tank display will be illuminated.

- (12) To drain the collection water tank, remove the outlet cap, pull out the rubber plug and drain the water into a suitable tray. To drain the pure water tank, press two times refrigeration ON/OFF button to drain out water from the outlet. If the machine is going to be disconnected from power for a long period of time we recommend you drain the tank.

- (13) Ambient temperature and humidity. If the ambient temperature is below 15°C or humidity is below 25%. The compressor will not

run until the temperature is within range. The Temperature and Humidity indicators on the display will be flashing.



10. Care & Maintenance

- 1) Clean the surface of the machine with a dry or damp cloth .
- 2) Turn off the machine, clean the air intake grill.
- 3) Clean collection water tank about 3~6 months to maintain high quality drinking water.

Attention: When Cleaning

- 1) Clean the machine at least once per week.
- 2) When cleaning remove the power cable from the outlet.
- 3) Do not use hot water, any strong chemicals or solvents to clean the machine. Use a damp cloth with a mild soapy solution only.
- 4) Remove washable pre-air filter, clean with a damp cloth and wipe dry before replacing.
- 5) Do not hose or wash down the machine, it may result in short circuit damage and corrosion within the machine.
- 6) After cleaning check the power cord and connector is free from damage and moisture.
- 7) If the machine has been left standing and unplugged from power for a long period of time. First drain the water tank and dry off the machine before turning the power on again.

⚠ Do not wash main air filter or wipe with damp cloth

Open collection water tank

- 1) Twist 4 screws at the bottom of back panel
- 2) Open back bottom panel and loose the fixed buckle at the top of collection water tank
- 3) Pull water pipe and three wire connectors
- 4) Remove collection water tank

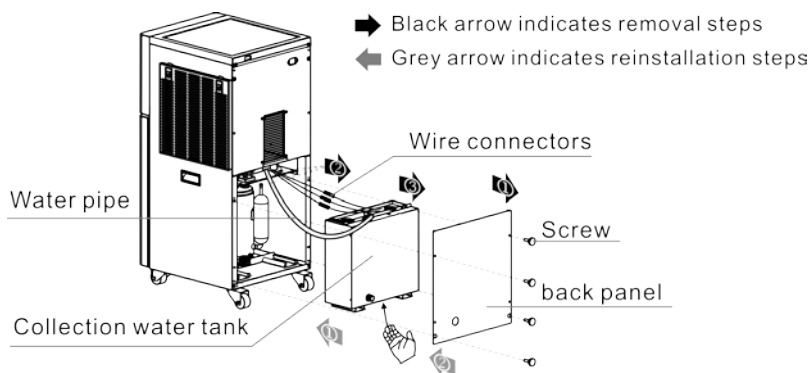

Attention: It is highly recommended to contact your local service center for removal and reinstallation collection water tank.

11. Air Filter Replacement and Reset

The machine has microcomputer control of the air filter. It will give a Red Renew warning on the display when the air filter needs to be changed.

- 1) Leave power on. Press On/Off button and turn the water making off.
- 2) Wait 60 seconds for the fan to stop if the fan was running.
- 3) Remove air filter.
- 4) Install replacement filter.
- 5) Reset the air filter, Press and hold On/Off and Water button together for 3s, air filter indicator will turn to green.



- 6) Press On/Off button to turn the machine back on.

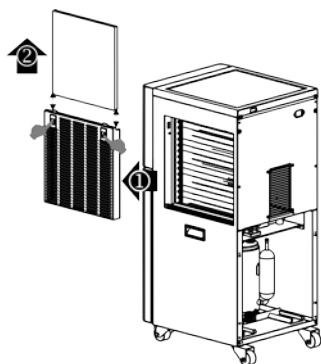

Removal

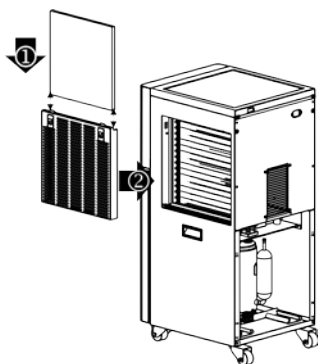

Reinstallation

12. Water Filter Replacement and Reset

The machine has microcomputer control of the water filters. The display will show the condition of the water filters. When the filters need to be replaced the display will begin red flashing to indicate.

- 1) Open water filter door.
- 2) Remove the filter to be replaced.
- 3) Install replacement filter.
- 4) Close water filter door.
- 5) Reset new water filter, press and hold ON/OFF and Refrigeration ON/OFF button together for 3s, water filter indicator will turn to green .

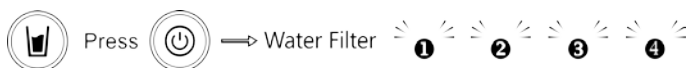

- 6) Press On/Off button on the machine to turn back on.

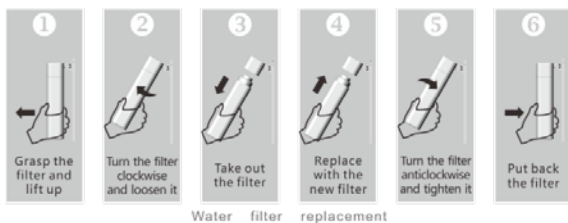

Water filter replacement

P5

Reminder: It is important to change the water filters on time to ensure high water quality.



Attention: It is highly recommended to contact your local service center to arrange for replacement filters or any repairs on the machine.

13. External Water Inlet

- 1) Open the water inlet door.
- 2) Pour water into the opening.
- 3) Take care not to spill excessive amounts of water.
- 4) Stop filling the tank when the water level “H” light is illuminated.
- 5) You can use bottled or municipal water to fill the tank.

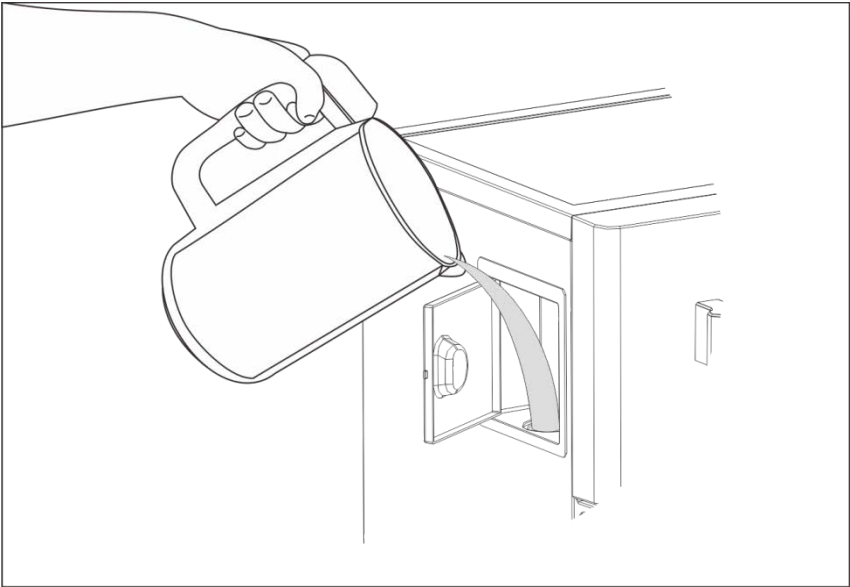

14. External Tank Adapter

The function of the External Tank Adapter is to connect directly to the collection water tank.

WARNING: THE COLLECTION WATER TANK WATER NOT FOR DIRECT DRINKING

- 1) Remove the Drain Cap and Rubber Stopper.
- 2) Connect the External Tank Adapter Kit to the Water Outlet.
- 3) Ensure the pipe rises upwards from the Water Outlet.

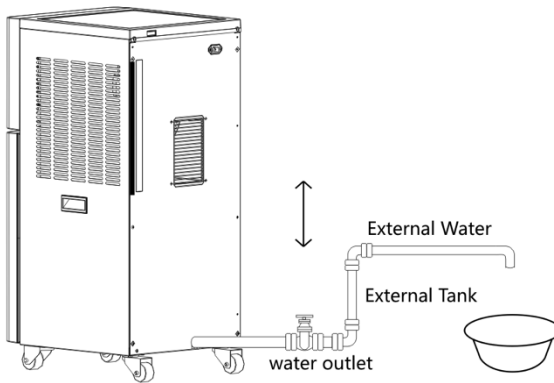

15. Trouble Shooting

Problem	Possible Cause	Solution
Water production is very slow.	Ambient temperature or humidity is out of working range.	Use the external water supply until the temperature or humidity is in working range.
	Air circulation is poor.	Place the unit in an area with better air circulation.
	The air intake is blocked or restricted.	Remove obstructions and ensure machine is not too close to the wall.
	Machine is running in Quiet Mode.	Press Quiet button to run the fan at normal speed.
Water production stops	Reset the main power switch on the back of the machine.	The machine will restart automatically.

	The high level water indicator is illuminated.	The machine will not produce water if the water tank is full.
	E1 or E2 warning on display.	Contact local service centre.
	Ambient temperature or humidity is out of working range.	The compressor will not run if the ambient temperature is below 15 °C or above 43 °C or if the humidity is below 25%
	Unsteady Voltage	Install a voltage regulator.
Water production stops before water tank is full	The ambient temperature is above 43 °C	The compressor will stop running for 3 minutes due to high ambient heat then restart.
The machine is too noisy	The machine is not levelled correctly.	Check the machine is levelled correctly.
	External water supply or bottom door is not closed properly.	Check the External water supply or bottom door are closed properly.
	Are there items on top of the unit?	Remove any items from the machine.
Water does not dispense	Water filters are not filled with water.	Wait until water level in the water tank increases.
	Low water level light flashing.	Wait until water level in the water tank increases.
The machine is leaking water	If the machine was moved or not levelled correctly the water tank may have spilled.	Dry off the machine. If the leak continues unplug the machine and contact local service centre.
Water dispenses slowly.	The filters need to be replaced.	Follow steps in section 12.

16. Fault Codes.

E1 code indicates temperature sensor is faulty.

E2 code indicates humidity sensor is faulty.

E3 code indicates the collection water tank level sensor is faulty.

E13 code indicates exhaust temperature sensor is faulty.

E14 code indicates evaporator temperature sensor is faulty.

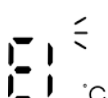
E1 
Temp

E2 
Humidity

E3 
Temp

E13 
Temp

E14 
Temp

17. Technical Specifications

Model: KLR – 50LA	Water Tank Volume: 15L	Storage Temperature -10° C – 60° C
Frequency: 50 Hz	Total Power: 1230W	Operating Temperature: 15° C – 43° C
Rated Voltage: 220 V ~240V	Water-making Power: 1230W	Storage Humidity: 5% - 80%
Current: 5.7A	Net Weight: 49kg	Operating Humidity: 25% or above
Refrigerant: R410a	Refrigerant Volume: 570g	Anti-shock: I
Waterproof: IPX0		
Dimensions: (W x L x H) 400 x 473 x 920 (mm)		
Capacity: 50L/Day (@ 30° C and 80% humidity)		

18. Packing List

Item	Quantity	Unit
Atmospheric Water Generator	1	pc
User Manual	1	pc
Warranty Card	1	Pc
Power Cord	1	Pc
Water Filters	1	Set
PP Sediment Filter	1	pc
Air Filter	1	pc
Washable Pre-Air Filter	1	pc
Drain Valve	1	pc
Water Pipe	1	pc

19. Replacement Filters

UF System (Water Filters)	Description	Part Number
		P50MC1 P50CT2 P50UF3 P50MU4
Air Filter	3 in 1	Part Number
		1. HEPA Cotton Filter 2. Activated Carbon modified molecular Sieve 3. PP Cotton

20. Circuit Diagram

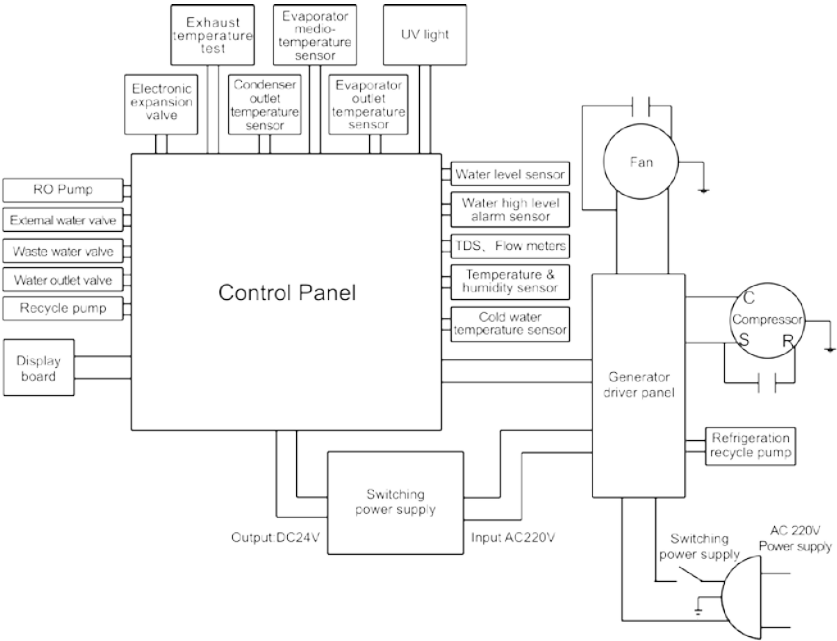

Remark: the above map is for your reference only, please take the map on the name plate of the machine as right one.

21. Warranty

All Better is confident of the quality of its products and offers a 1 year limited warranty from the date of purchase and covers any defect in materials or workmanship under normal use during the warranty period.

- **Cover**

During the warranty period the Authorised Distributor & Service Centre will repair or replace, at no charge, products or parts of the product that proves defective because of defective material, components or workmanship, under normal use during the warranty period.

- **When is the warranty not covered?**

The limited warranty does not cover any problem that is caused by conditions, malfunctions or damage not resulting from defects in materials or workmanship. If the machine has been tampered with or serviced by an unauthorised person. Air and water filters are not covered by the warranty and considered as consumable components.

- **What do you have to do?**

To obtain warranty service, you must contact the Authorised Distributor in your region. Contact details can be found on the back page of this manual.